



Rotax MAX Challenge Technical Regulation 2017 Appendix for 125 Micro MAX and 125 Mini MAX

(The Technical Regulations 2017 replace the Technical Regulations 2016)

Version 1 January 2017

The 125 Junior MAX engine is the basis for the engine configurations 125 Micro MAX and 125 Mini MAX.

In this appendix just the deviations for 125 Micro MAX and 125 Mini MAX from the standard Technical Regulation for the 125 Junior MAX engine are defined.

Appendix on 1.1, Categories

95cm karts used in the Rotax Mojo MAX Challenge (RMC) and International Rotax Mojo MAX Challenge Events (IRMCE) are divided into the following classes:

125 Micro MAX

125 Mini MAX

Classes	125 Micro MAX	125 Mini MAX
Age limits	7 – 11 years	10 – 13 years
* Chassis wheel base	950 mm	950 mm
Weight limits	110 kg	120 kg
Dry tires	Mojo C2	Mojo C2
Wet tires	Mojo W2	Mojo W2

*The chassis and rims should comply with the 2017 regulations typical of Maxterino and Mini Rok in South Africa. It is permissible to cut a section out of the side pod and bar and plastic body where applicable to accommodate the radiator. See “Supplementary Technical Regulations 2017” for details.

Appendix on 5.1, Squish gap

125 Micro MAX/evo minimum = 2,40 mm

125 Mini MAX/evo minimum = 2,40 mm

To achieve the defined minimum squish gap one spacer (Rotax part no. 626 420, with same shape as cylinder base gasket) in combination with at least two cylinder base gaskets (one below the spacer and one above the spacer) must be used.

The squish gap must be measured with a certified slide gauge and by using a 3 mm tin wire (Rotax part no. 580 132).

Appendix on 6.7, Ignition system

Both versions of ignition systems (Denso and Dellorto) are legal to be used.

Version 2, Dellorto ignition system

The electronic control unit (ECU) is labeled with a sticker and is still legal also if the sticker is unreadable or disappeared.

125 Micro MAX and 125 Mini MAX: “666814MAX / 666815MAX”

The ECU tester has to show following result:

125 Micro MAX and 125 Mini MAX categories

① 666814MAX / 666815MAX

② !! Test OK !!

NB! ONLY SENIOR MAX ECU, NO JUNIOR MAX OR DD2 ECU ALLOWED

Appendix on 6.10, Carburetor

For the 125 Micro MAX class (to achieve best performance characteristic) it is recommended and allowed to adjust the accelerator stop for an opening of the carburetor slide in the range from 22 to 26 mm (measured from closed position).

An aluminium stop sleeve as shown in the photo with a height of 29.45 +/- 0.10 must be fitted. The top of the carburetor must be tightly fitted at all times. It is extremely dangerous to consider unscrewing the top of the carburetor – if this comes loose the driver will have maximum acceleration with no control.



Appendix on 6.12, Radiator 125 Micro MAX

A specific radiator has to be used for the 125 Micro MAX engine.

Two different versions as shown in the illustrations are legal to be used.

Cooling area:

Height = 280 – 300 mm

Width = 58 – 62 mm

Thickness of radiator = 30 – 34 mm

To remove the original flap is an allowed modification (valid for version 2, right illustration).

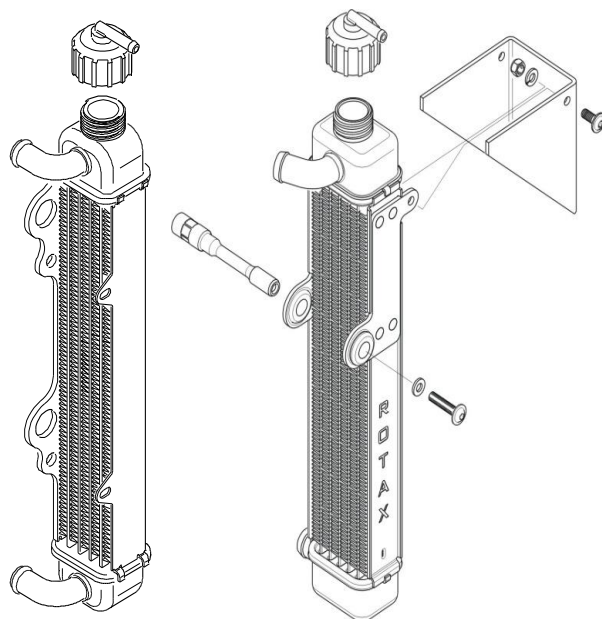

Appendix on 6.13, Exhaust system

Just exhaust sockets with gasket ring are legal to be used. From 1 March 2017 the engine seal must include passing through one of the spring attachment points on the exhaust socket. Alternatively an additional Rotax seal that attaches the exhaust socket to the existing engine seal must be added. This can be done by any service center.

Diameter (A) must apply for a length (B) of at least 12 mm.

Maximum inner diameter (A) of exhaust sockets are:

125 Micro MAX: 18,20 mm

125 Mini MAX: 20,20 mm

The measurement (C) must be at least 18,5 mm.

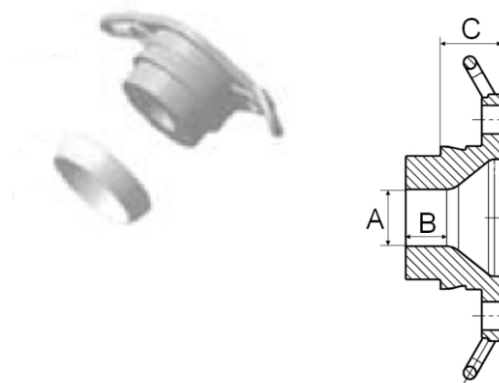

125 Micro MAX

A specific exhaust system has to be used for the 125 Micro MAX engine.

The inner diameter of the elbow outlet at the silencer end cover has to have a minimum measurement of 21 mm



Jetting and Gearing

	Sprockets		Jets Inland		Jets Coastal	
	Micro	Mini	Micro	Mini	Micro	Mini
Zwartkops / Idube / PE	14:75	13:77	108-112	118-122	102-112	118-125
Vereeniging / Cape Town	14:70	13:73	108-112	118-122	102-112	118-125

NB! Jetting and gearing may be altered during the season. A minimum of 30 days' notice will be given.